

Gardens at Night Standard Joining Method

The Standard Joining Method is used for electrical connections and environmental sealing of joins in well-drained soils and garden beds. Joins are soldered and adhesive lined end caps are used. The light fittings below require Standard Joining Method. Refer to Technical Resources page to view or download product specific Installation Sheet.

- Accent 5 & 8
- Path Light Dome 110
- Path Light Linear 112
- Pole Light Single 5
- Pole Light Twin 10
- Bollard Linear 8
- Step Light Linear 80
- Step Light Round 100
- Step Light Linear Recessed 120, 210
- Step light Round Recessed 90
- Neon Side Flex
- Power Supplies

FITTING INSTALLATION INSTRUCTIONS

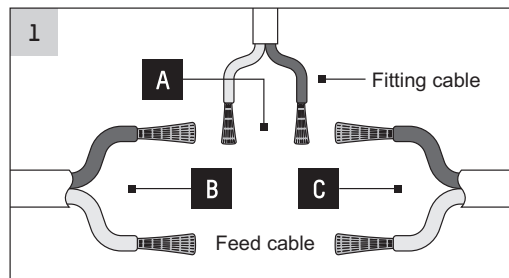

- Cut and remove two solid tinned ends from fitting cable.
- Strip PVC insulation from fitting cable to expose strands (A).
- Cut incoming feed cable from power supply (B).
- Strip PVC insulation to expose copper strands from incoming feed cable (B) and exiting cable (C).

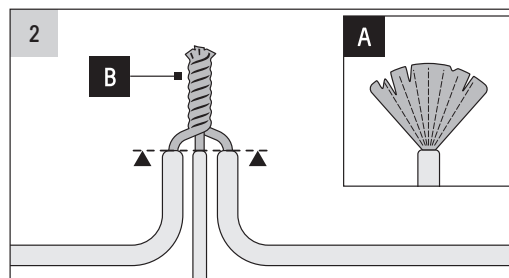

- Fan out all exposed copper strands (A).
- Tightly twist red fitting, feed and exiting cable (B), ensuring shoulders of PVC insulation remain aligned.
- Repeat for black cables.

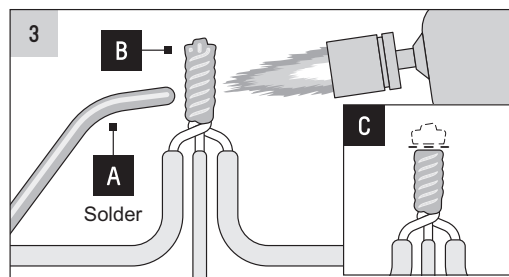

- Heat twisted copper with Butane Gas Torch* and apply solder (A).
- Solder should fully penetrate all strands (B).
- Trim solder with side cutters and carefully remove any sharp edges (C).
- Repeat for other cable join.

NOTE:

1. Gardens at Night fittings should only be connected to approved Gardens at Night 24VDC or 48VDC Constant Voltage (CV) Power Supplies. FAILURE TO DO SO WILL VOID WARRANTY.
2. Gardens at Night fittings must be wired in parallel and connected in accordance with installation instructions provided (including soldering of cable joins and sealing using Adhesive Lined End Caps). FAILURE TO DO SO WILL VOID WARRANTY.
3. Fittings are polarity sensitive and need to be connected red (+) fitting lead to red (+) incoming and exiting feed cables and black (-) fitting lead to black (-) incoming and exiting feed cables.
4. Do not carry fittings by lead as it may cause damage.
5. Do not connect fittings to constant current (CC) power supplies or AC transformers as this will cause permanent fitting failure and VOID WARRANTY.

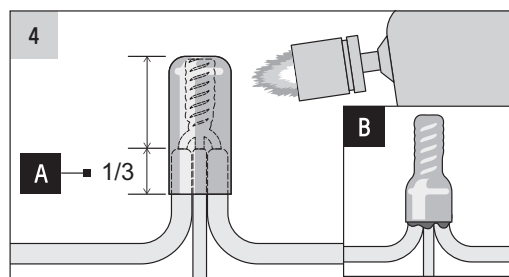

- Place Adhesive Lined End Cap** over soldered join.
- Ensure 1/3 (minimum) of cap length overlaps PVC insulation (A).
- Apply heat gently to end cap. Cap will collapse and encapsulate the join (B). Adhesive should be visible from the base of the cap.
- Repeat for other cable join.

* Butane Gas Torch and solder available from Gardens at Night.

** Adhesive Lined End Caps are available in various sizes to suit different low voltage cable sizes. Caps should be at least 1/3 larger than join and are available from Gardens at Night.

gardens at night[™]
 ■ ■ ■ ■ professional lightscaping

Gardens at Night are landscape lighting specialists that manufacture quality, energy efficient outdoor lighting. For information and inspiration on lighting your landscape and to find a distributor visit www.gan.com.au.